

CAM-KIT11 4.3" Wireless Monitor & Camera

PRODUCT FEATURES:

Monitor

Display Screen:	4.3" TFT Colour Digital Display
Mounting:	Suction Cup or Bracket (Both options provided)
Effective Pixels:	480 x RGB x 272
Viewing Angle:	Up 50 degrees, Down 70 degrees, Left 70 degrees, Right 70 degrees
Brightness:	500cd
Contrast:	350:1
TV System:	NTSC/PAL
Parking Lines:	Yes
Removable Lines:	Yes
Monitor Image Adjustment:	Yes (Mirror/Normal/Inverted & Inverted Mirror)
Operating Voltage:	12-32V DC (Negative Ground)
Current Consumption:	160mA
Operating Temperature:	-20 Degrees C to +80 Degrees C
Storage Temperature:	-30 Degrees C to +80 Degrees C

Camera

Sensor:	OV7725
Array Size:	640 x 480
Lens Size:	1/4"
Max Image Transfer Rate:	60fps for VGA
Lens:	2.5mm
Resolution:	420 TV Lines
Waterproof:	IP69
Operating Voltage:	9-30V DC (Negative Ground)
Current Consumption:	150mA
Low Light Feature:	LED lights built in for night vision
Mounting Brackets:	3M adhesive/screw-on numberplate bracket

Wireless Information

Transmitting Distance:	Up to 50M (in open area)
Power On:	3 sec max
Latency:	120ms max
Resolution:	480 x 272
Frame Rate:	30fps max
Video Decode:	MJPEG decode
ID:	Pairing

CONTENTS

- 4.3" Monitor with Antenna
- Adjustable Stand
- Suction Cup Mounting Bracket
- 4M Cigar Lighter Plug - Micro USB Power Cable (for monitor)
- Camera with 2 x Metal Mounting Brackets
- 2M Cable to + & - Wire Connections
- Instructions

Camera

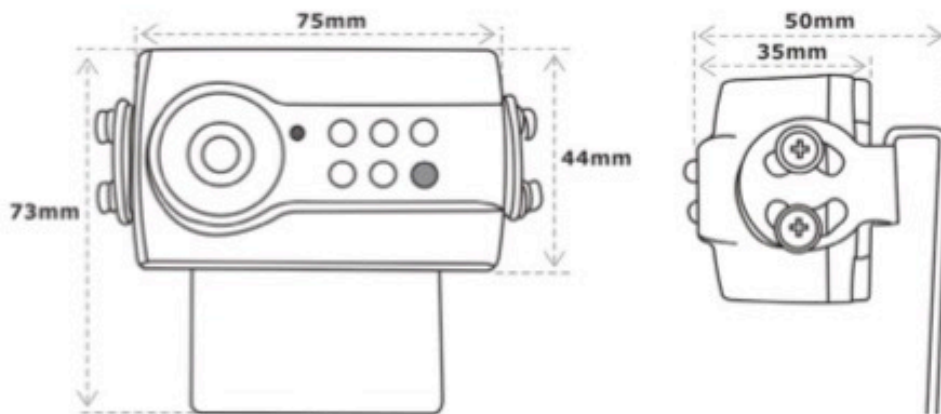

Monitor

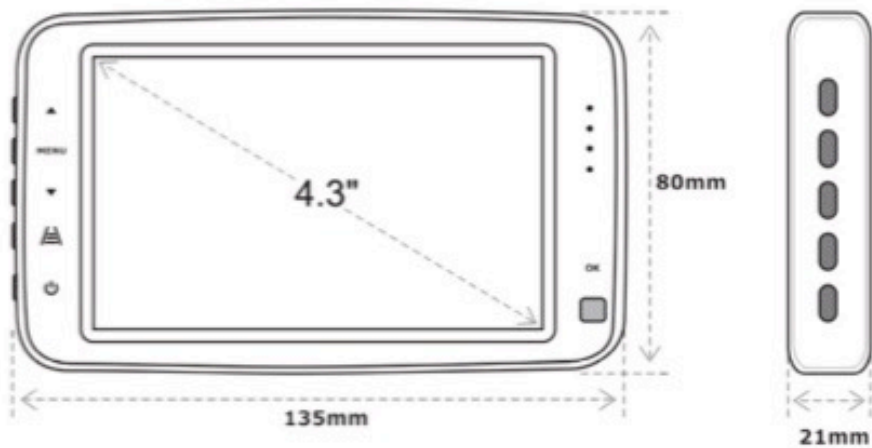

INSTALLING THE MONITOR

Caution: As with any accessory being placed into a vehicle, you must ensure that it in no way affects the correct operation or deployment of any vehicle manufacturer's safety measures, such as safety restraints, air bags etc.

1. The monitor is supplied with two mounting bracket options, one for attachment to a vehicle glass windscreen/windshield and the other, adhesive foot bracket, to any flat surface.

NB: Please note that when using either bracket, the drivers view out of the windows of the cab should not be compromised when viewed from the driving position.

2. Any surface to which the 'foot' bracket is attached should be adequately cleaned of any contaminants first to ensure good adhesion.

3. The monitor should be attached to the chosen bracket.

4. Connect the supplied Cigar lighter to Micro USB power cable to a suitable outlet and safely route the cable to the monitor and plug it in.

5. Power up the system (ignition on, reverse engaged if camera connected to 12V reverse +, Cigar lighter plugged in, and switched on), so power is going to both the monitor and camera and carry out pairing procedure shown below.

6. Check that the image from the camera is displayed correctly on the monitor. Adjustment of the camera may be required to ensure that the correct angle of the image is achieved and that the distance markers on the parking lines correspond to that of the object in view.

7. Parking lines can be selected in the monitor menu.

8. To adjust the image type, follow the process shown below.

INSTALLING THE CAMERA

1. Decide on the most appropriate mounting location and bracket for your particular needs and attach the bracket to the vehicle and the camera to the bracket with the supplied screws (Camera is attached to the registration plate mounting bracket for shipping).

2. Route the cable, which incorporates the transmitting antenna, into the vehicle.

NB: This can be achieved either through an existing hole or gap (e.g. between body trim and bodywork), or may require the installer to drill and prepare a dedicated hole for the supplied grommet to fit within. This can be accommodated behind the registration plate in some applications.

3. Once routed inside the vehicle, connection is required to ground (black wire) and power (red wire).

4. Reinstall all original trim and parts (e.g. registration plate).



PAIR



LCD SETTING



Mirror Mode



VERSION

PAIR



LCD SETTING

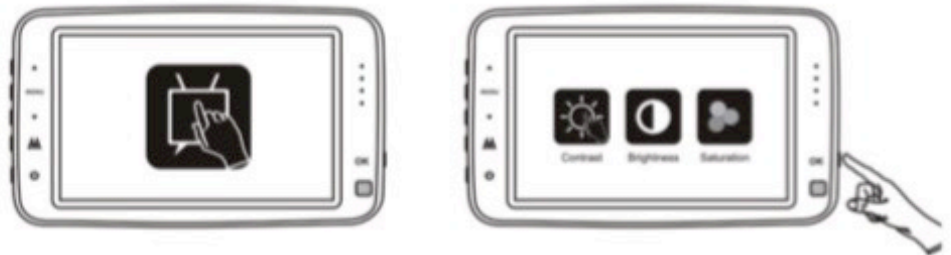

MIRROR MODE

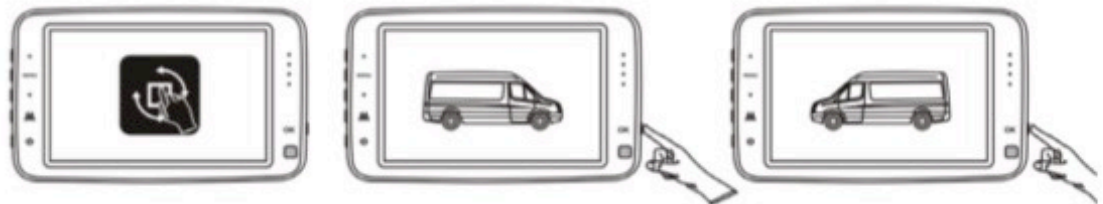

FREQUENTLY ASKED QUESTIONS

Q: Is the signal between the camera and the receiver encrypted?

A: Yes

Q: How many cameras does the system support?

A: One camera

Q: Why does the frame rate sometimes drop when I'm driving?

A: When driving, the signal reception may drop sometimes. This occurs as the signal to the receiver is constantly transmitted from different angles. This is considered normal when transmitting a wireless signal.

Q: Is the camera water resistant?

A: The camera is IP69 rated. This means that the camera is well protected from both dust and humidity. It can be placed outside the vehicle and cleaned using a pressure washer with no issue.

Q: Can I hear sound from the camera?

A: No, the camera does not have a microphone

Q: I am using the camera for reversing. How do I mirror the image?

A: Please see the 'Mirror Mode' section of this manual for more details

Q: Will the camera break at very low temperatures?

A: No, at very low temperatures the picture may tone red. At extremely low temperatures, the camera might turn off. When the temperature rises again, the camera will regain its normal functionality.

